

7.2 AFTER-SALES SERVICE

The Manufacturer is always willing to answer Customer's questions and give information on use, maintenance or installation and so on. Please follow the instructions given under paragraph 1.2 on how to request our assistance.

8 SPARE PARTS

8.1 SPARE PARTS LIST

Filtering unit use does involve some expendable parts. Following is the list of available spare parts and expendable parts.

Table 8.1- A

POS.	DESCRIPTION	PART NO.
1	Solenoid valve	A: 9018 B: 9029
2	Pressure regulator	F1: PCX-0001 F2-F3: 6709
3	Pressure gauge	K2-78
4	Dedusting device	K5-0080
5	Filter cartridge	K5-38-C-Alum.
6	Top seal	F1: 7860-0134 F2-F3: 7867
7	Bottom seal	7867
8	Differential pressure gauge	8153
9	Dust collection bag	99987



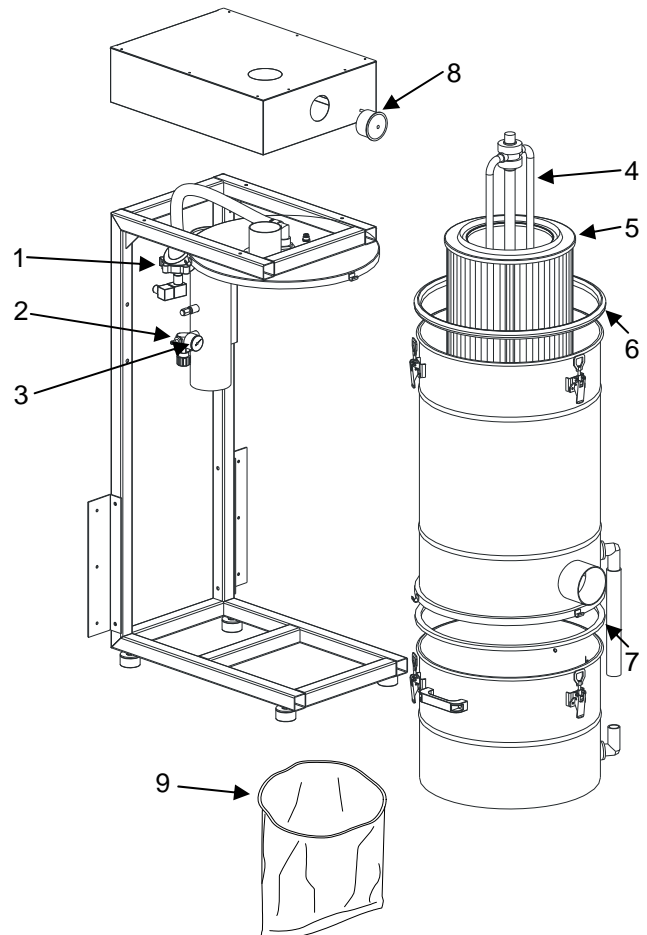
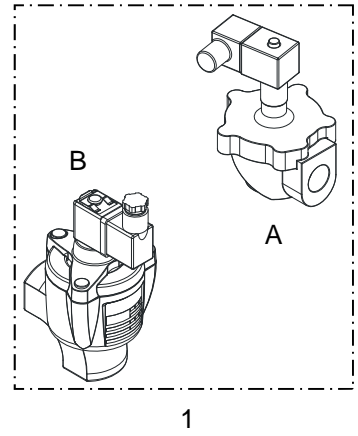
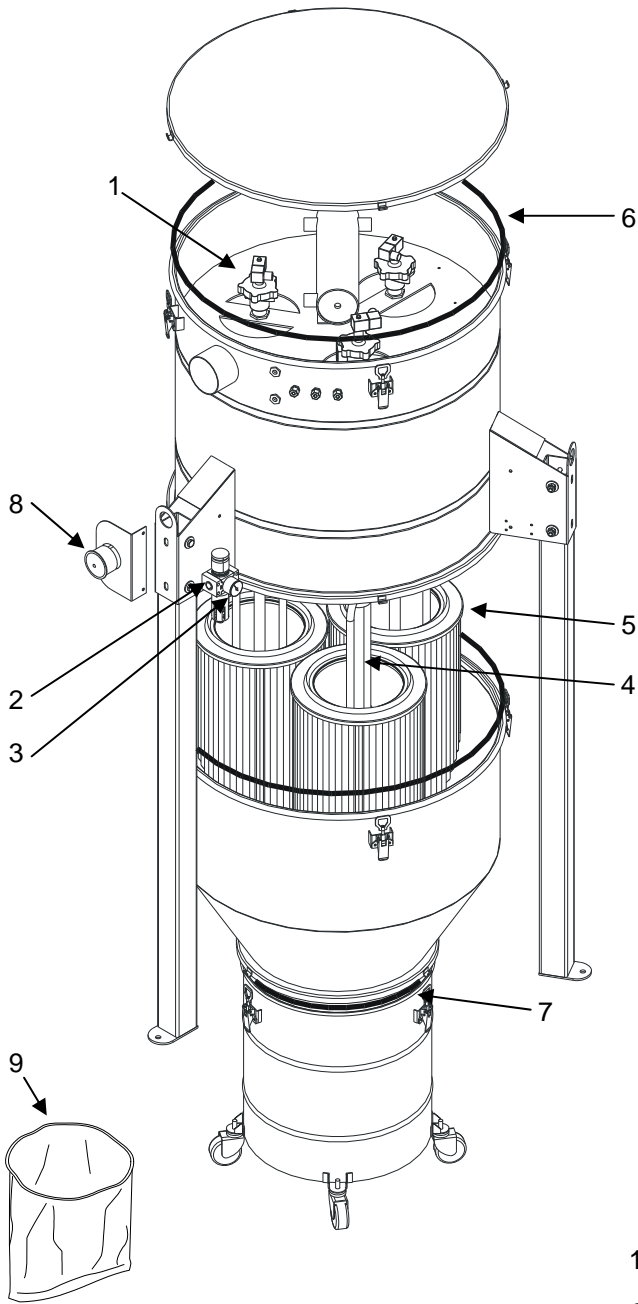

Please see descriptions in Table 8.1 A